

SUMMERS

6TH. AVE.

STREET.

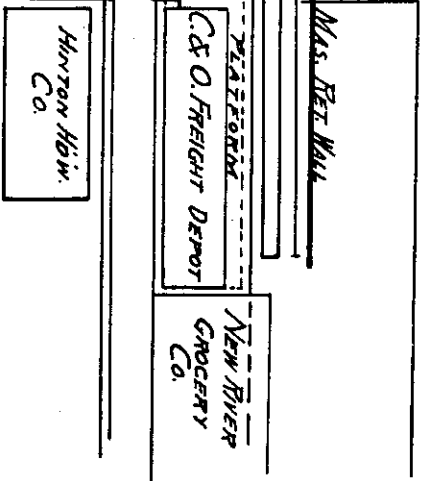

SITUATION PLAN.
SCALE 1/2" = 10'

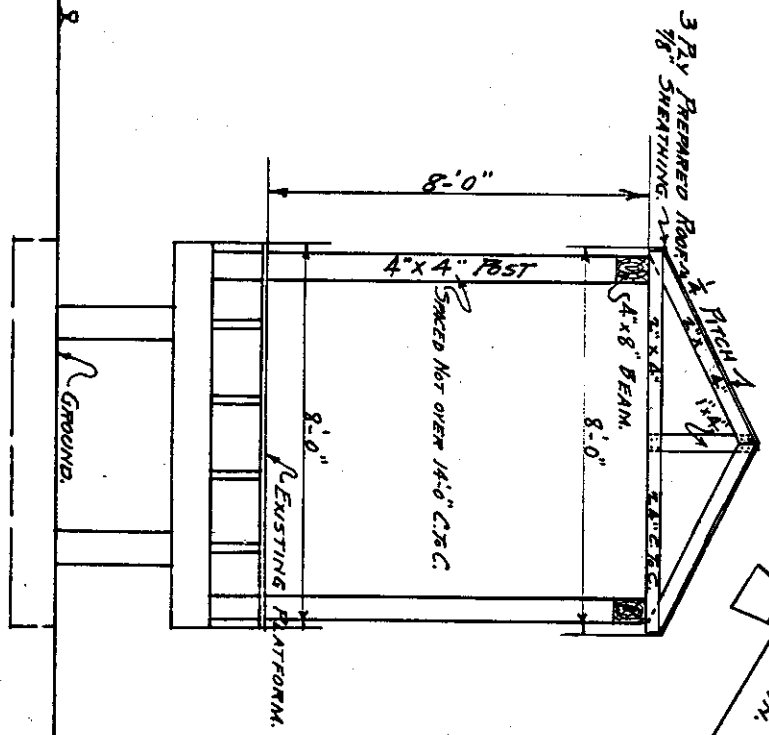

SECTION.
SCALE 3/4" = 10'

THE CHESAPEAKE AND OHIO RY. CO.
 CHIEF ENGINEERS OFFICE RICHMOND, VA.
 PROPOSED SHED OVER
 EXISTING PLATFORM
 HINTON, SUMMERS Co., W. VA.
 HINTON DIV ALLEGHANY DIST.

SCALE: AS NOTED
 DATE: June 8, 1917
 DRAWN BY: E.L.P.
 TRACED BY: E.L.P.

Drawing No.
 X-1256

FOLDER NO. 1032

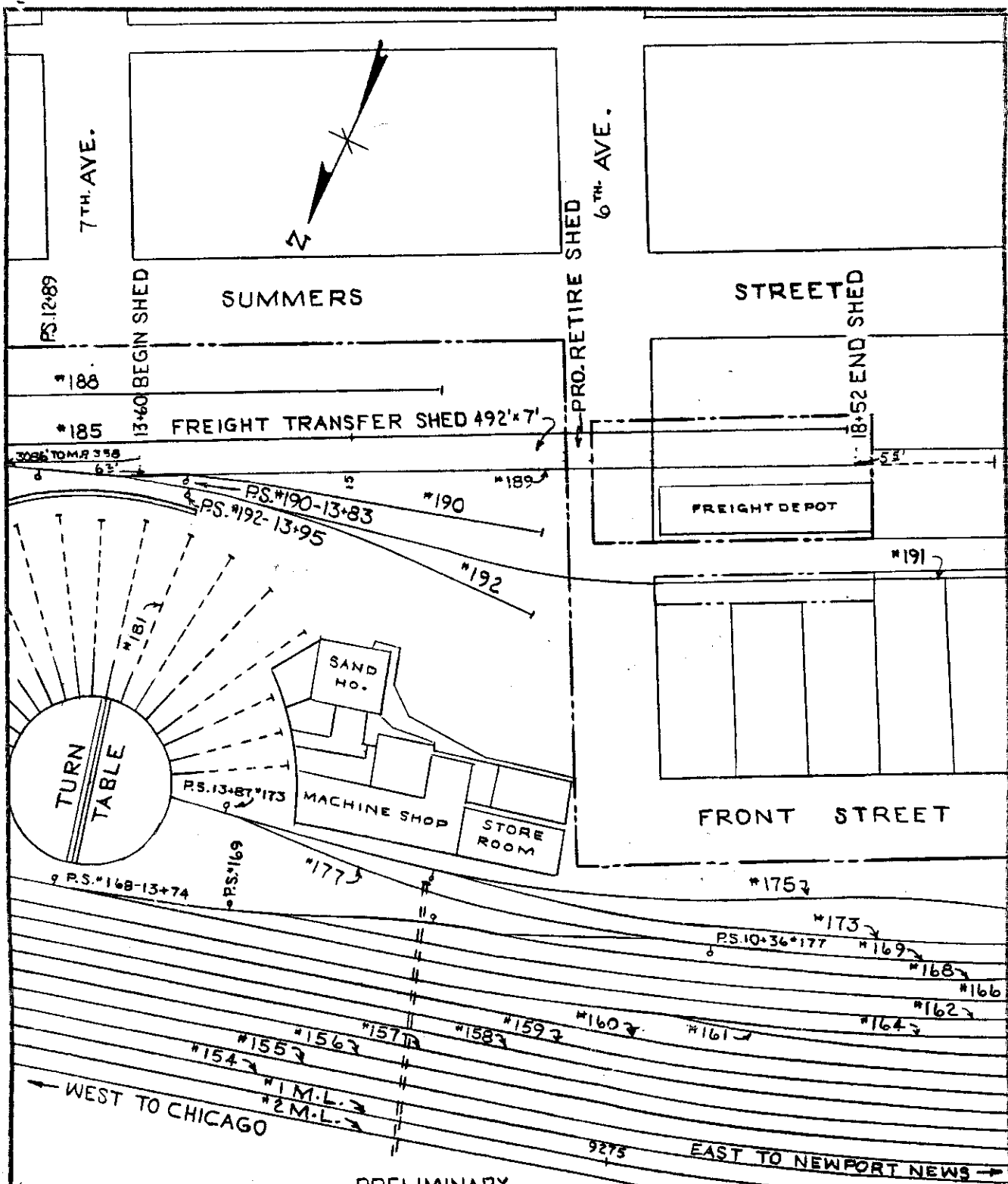

PRELIMINARY

~ LEGEND ~

EXISTING FACILITIES
 FACILITIES RETIRED
 AFE 26079
 DATE REMOVED: 7-21-65
 REMOVED BY
 ARNIE SPADE OUTSIDE PARTY

REVISIONS

THE CHESAPEAKE AND OHIO RAILWAY COMPANY
 CHIEF ENGINEERS OFFICE - HUNTINGTON, W.VA.

AS RETIRED
 FREIGHT TRANSFER SHED
 HINTON
 SUMMERS COUNTY - WEST VIRGINIA
 HINTON DIVISION — NEW RIVER SUB-DIV.

SCALE: 1" = 100'	VAL. SEC.	DRAWING NO.
DATE: 1-18-65	V-11	33241
DRAWN: J.J.C.	29	
CHECKED:		